

tasman[®]

ESSENTIALS

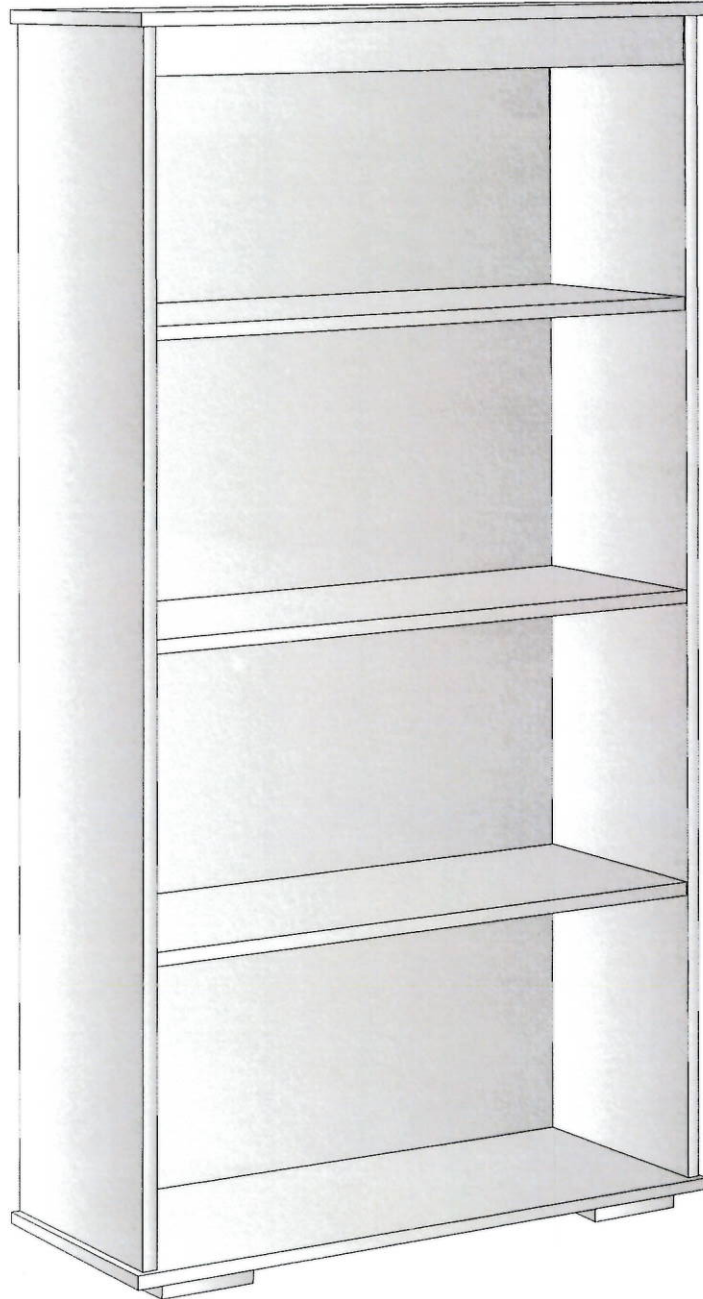

Bookcase

Assembly Instructions

Save these instructions for future reference.

Assembly of this furniture is best undertaken by two people.



Packaging and instructions
printed on recycled materials

SJC brands

SJC Brands Pty Ltd ☎ 58 106 988 578
4-6 Merryvale Rd, MINTO, NSW 2566 p o box 5878 MINTO DC, NSW 2566
t 02 9603 5000 f. 02 9603 7000 e info@tasmaneco.com.au
w www.tasmaneco.com.au

Parts List

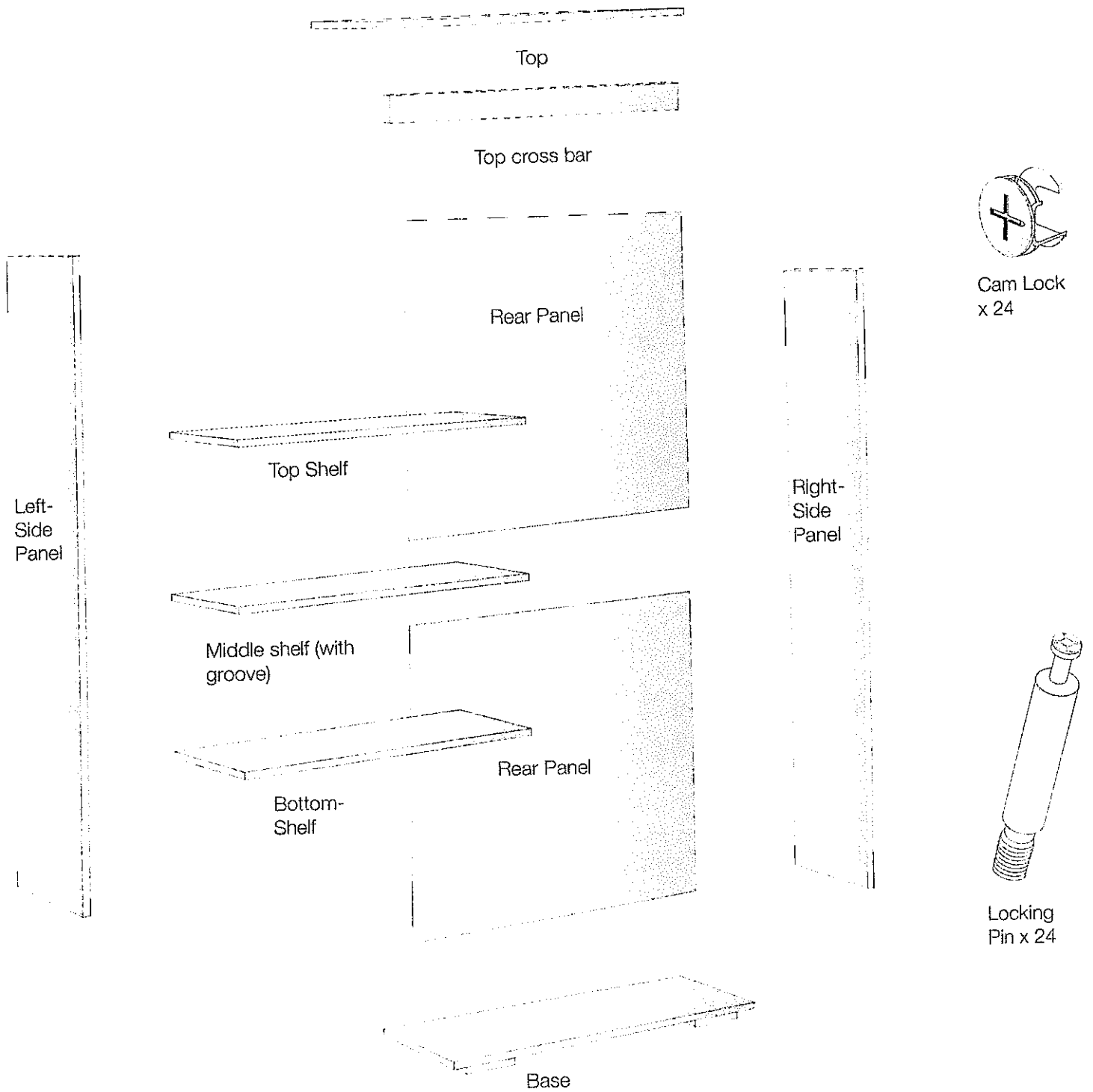

Due to the heavy nature of the bookcase, it is recommended assembly is undertaken by two people.

Warning

Read the instructions for your model.

- Do not place the bookcase in a position where it could be used to climb near windows
- Do not allow babies, toddlers and children to climb on the bookcase
- Regularly check the cam locks are tight

1 Fit all the Locking Pins

Screw all locking pins into threaded inserts with Phillips head screwdriver

- Base x 4
- Side Panels x 7 each
- Top x 6

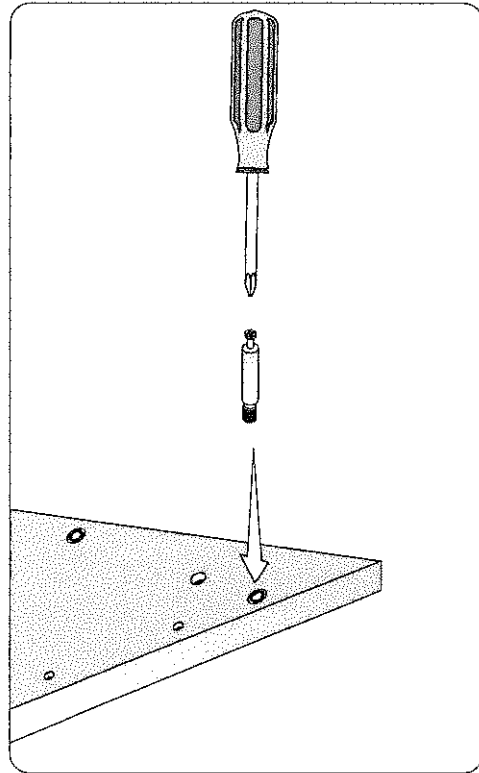

2 Fit all the Cam Locks

Insert all cam locks into large circular holes.

The small pointed arrow on the cam lock points in the direction the locking pin will insert from

- Shelves x 4 each
- Top cross bar x 4
- Side panels x 4 each

Use a Phillips head screwdriver to rotate cam into correct alignment.

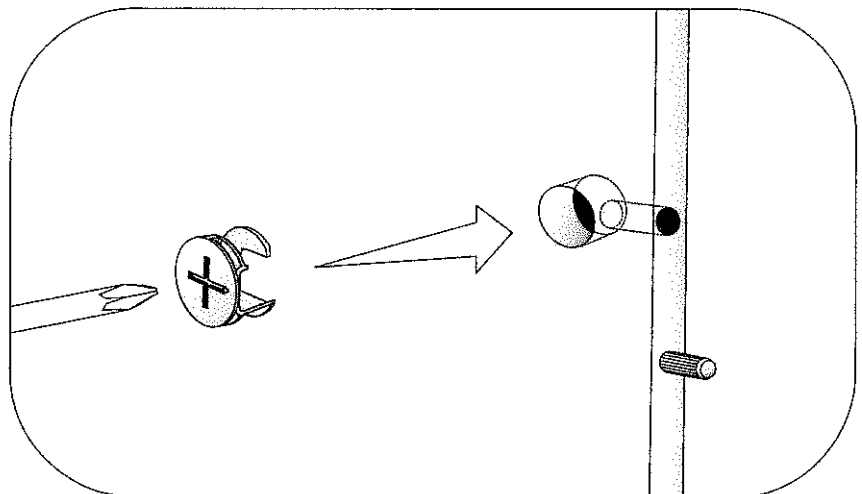

3

Fit Shelves and Top Cross Bar to Side Panel

Position all parts on the floor in the correct position and orientation

- Lay one side panel outside face down on the floor and locate the locking pin and dowel hole that are side by side at one end (this is the top of the bookcase). Locate the back of the side panel by the groove along one edge.
- Lay the middle shelf (identified by the groove in each side) on the floor alongside the side panel in position with the cam locks facing towards the bottom of the bookcase
- Lay the top and bottom shelves in position alongside the side panel with cam locks facing the bottom of the bookcase

Lay the Top Cross bar in position at the top of the bookcase

- Fit each shelf by aligning and inserting it onto the locking pins on the side panel (check the cam locks are facing downwards) and tighten the cam locks using a Phillips head screwdriver- do not overtighten
- Fit the Top Cross bar with the cam locks facing towards the back and the dowels pointing to the top, tighten the cam locks using a Phillips head screwdriver - do not overtighten

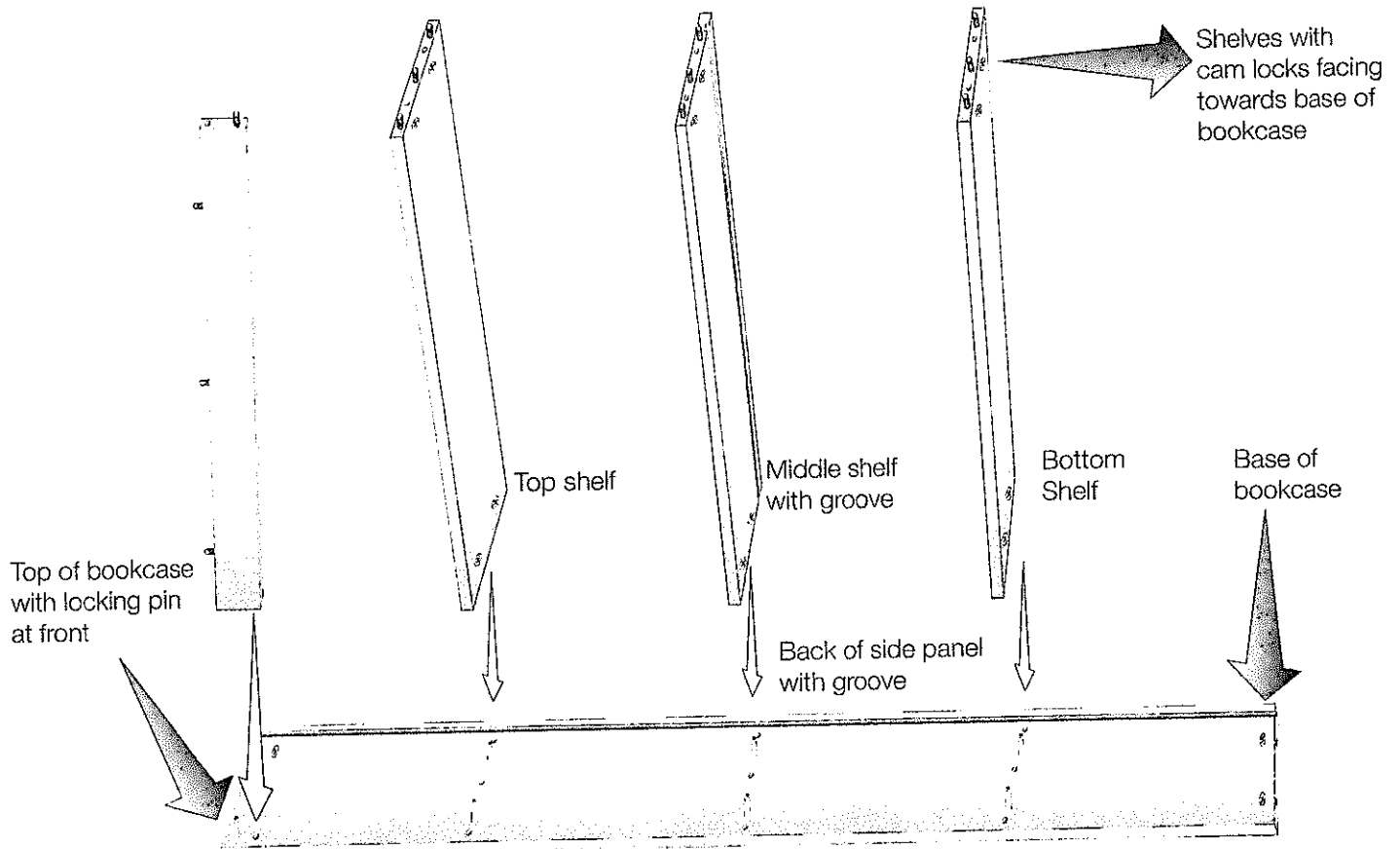

4 Fit other Side Panel

Identify the top and back of the other side panel and orient it with the shelves and side panel already assembled carefully lift and place the side panel onto the shelves and top cross bar aligning the locking pins and dowels with corresponding holes. When in position tighten all cam locks using a Phillips head screwdriver - do not overtighten

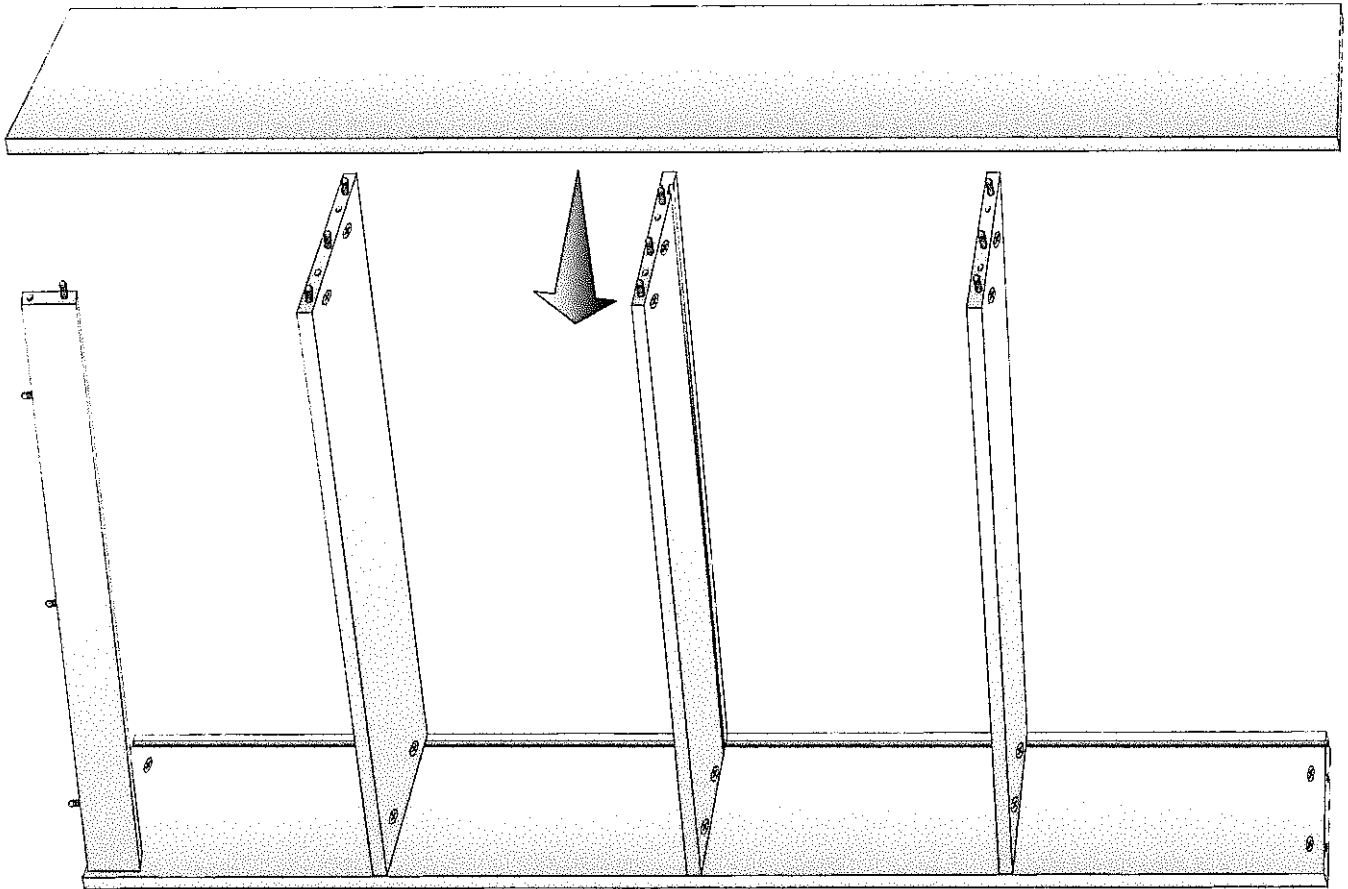

5 Fit Back Panels

- Slide the shelves into the grooves on the side panels and fit into the groove in middle shelf

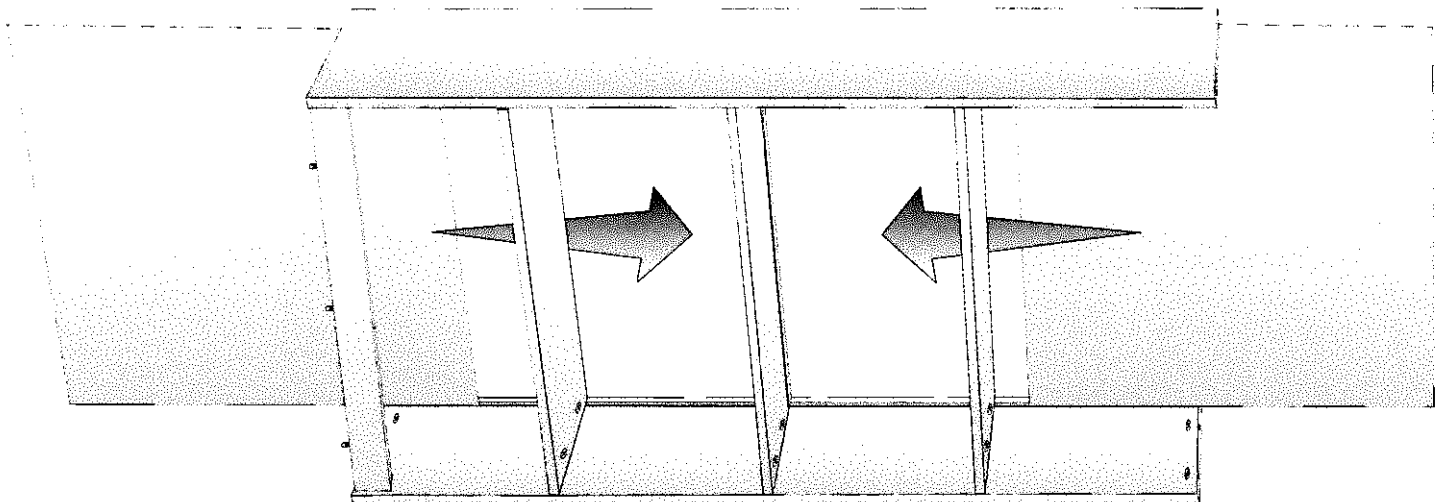

4

Fit Base

- Carefully lift assembled side panels and shelves 1 cm off the floor and fit base, aligning locking pins and dowels with corresponding holes
- Tighten all cam locks using a Phillips head screwdriver - do not overtighten

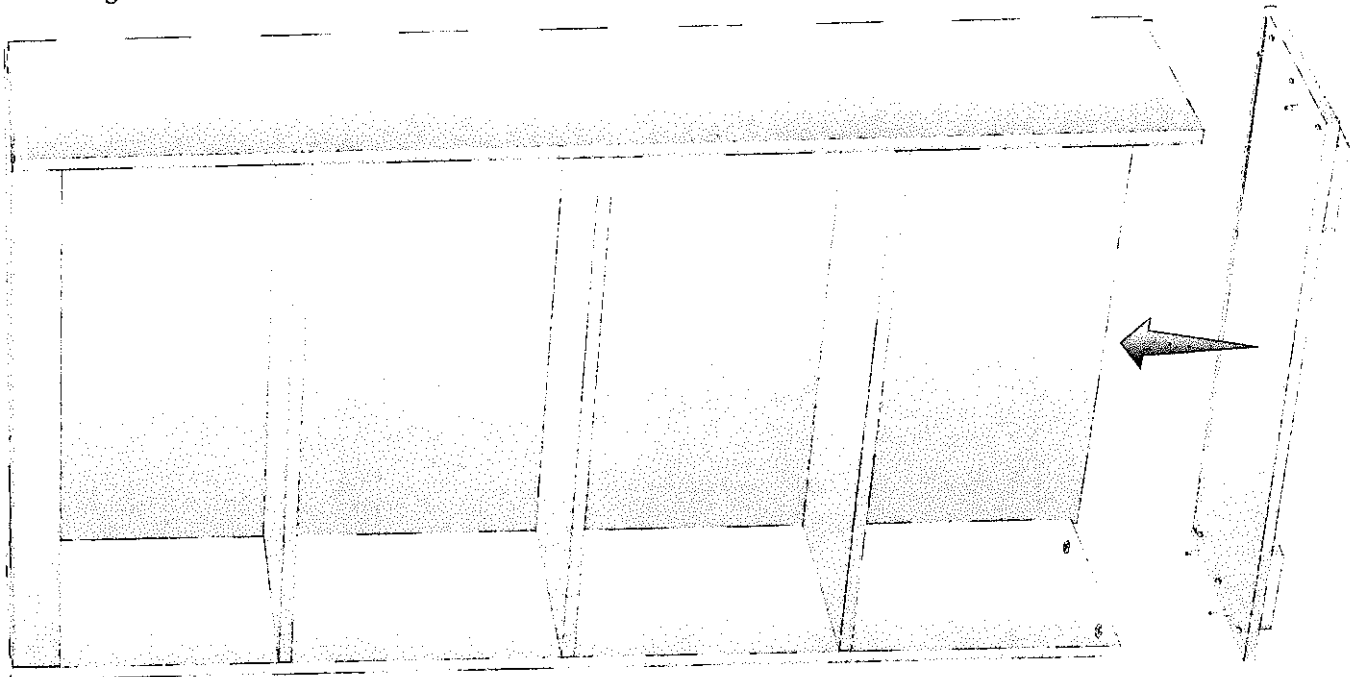

5

Fit Top

- Carefully roll bookcase onto its feet
- Fit Top onto assembled section aligning locking pins and dowels with corresponding holes
- Tighten all cam locks using a Phillips head screwdriver - do not overtighten

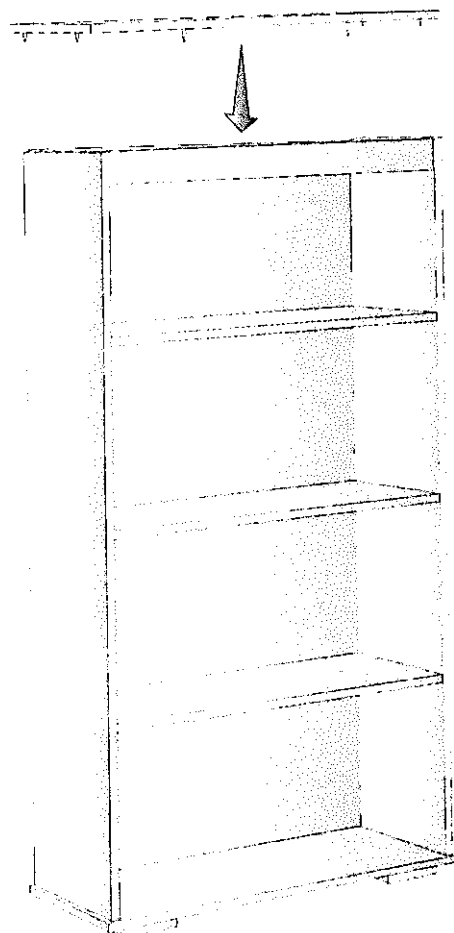

Maintaining Your Tasman Essentials Bookcase

To clean, wipe down with a soft cloth and soapy water. Avoid scourers and steel wool as these will damage the finish. Two months after assembling the bookcase, re-tighten all cam locks as some may loosen as it settles.



The Tasman Essentials Guarantee

Our goods come with guarantees that cannot be excluded under the Australian Consumer Law. You are entitled to a replacement or refund for a major failure and for compensation for any other reasonably foreseeable loss or damage. You are also entitled to have the goods repaired or replaced if the goods fail to be of acceptable quality and the failure does not amount to a major failure. The guarantee described below is in addition to the guarantee provided by law.

100% Satisfaction Guarantee

If, within 3 months of the date of purchase of this product, the purchaser is not completely satisfied with this product for any reason, subject only to the conditions below, the purchaser can return the product to the place of purchase or to SJC Brands Pty Ltd for a refund of the full purchase price of this product.

Conditions.

The 100% Satisfaction Guarantee is void and nullified in circumstances where:

1. There are modifications to the product or to parts of the product that were not authorised in writing by SJC Brands Pty Ltd.
2. There is damage to the product and that damage is deemed by SJC Brands Pty Ltd to be caused by incorrect assembly, misuse or by use or storage outside of the physical or environmental specifications of the product.

2 Year Materials and Workmanship Guarantee

If within 2 years of the date of purchase of this product, there is found any defect in materials or workmanship of this product, SJC Brands Pty Ltd, will replace the product free of charge, subject to the conditions below. The replacement product will be identical to the originally purchased product wherever possible, though in situations where the identical model is discontinued or out of stock, then SJC Brands Pty Ltd will replace the product with a model that is functionally equivalent.

This Guarantee is made to the purchaser and/or original owner only. For purposes of this Guarantee, the original owner is considered to be the person who first makes use of the product. Note: In situations where a person purchases this product for the purpose of gifting to another, the recipient is considered to be the original owner.

Conditions.

The '2 Year Materials and Workmanship Guarantee' will be void and nullified in circumstances where:

1. The item is improperly assembled or adjusted and or not assembled strictly in accordance with the written instructions provided by the seller in the box containing the item.
2. There is damage to the product and that damage is deemed by SJC Brands Pty Ltd to be caused by incorrect assembly, misuse or by use or storage outside of the physical or environmental specifications of the product.
3. There are modifications to the product or to parts of the product that were not authorised in writing by SJC Brands Pty Ltd.
4. The item is transferred, gifted or disposed of by the original owner to another.

Registration and Claims

To be eligible for the above Guarantees, the original owner must register their details online at www.tasmaneco.com.au immediately upon receipt of the product.

For claims under either the 100% Satisfaction Guarantee or the 2 year Materials and Workmanship Guarantee, please email us via our claims section on our website at www.tasmaneco.com.au or visit the store where the product was purchased.

The product must be returned to SJC Brands Pty Ltd or to the place of purchase with proof of purchase, including date and purchase price.



SJC Brands Pty Ltd ☎ 58 106 988 578
4-6 Merryvale Rd, MINTO, NSW 2566 📍 5878 MINTO DC, NSW 2566
📞 02 9603 5000 📠 02 9603 7000 ✉ info@tasmaneco.com.au
🌐 www.tasmaneco.com.au